



# Advance Carpet Tiles

For fiberglass reinforced PVC backed Gecko tiles

## Step 1

A pallet can carry up to 20 boxes. To prevent damage to the carpet tiles, 2 pallets should never be stacked on top of each other. There is a batch number on every box. Before laying, check that the tiles are from the same batch. It is important that batch numbers are not mixed within an installation in view of very slight colour variations which may occur from batch to batch.

## Step 2

To ensure optimal conditioning of tile backings, the temperature for fitting must be between 10°C and 25°C, at a relative air humidity of approximately 60%. The tiles should be removed from their outer boxes and laid loosely on the floor for 24 hours before laying so that they can become conditioned to room temperature guaranteeing stability.

## Step 3

There is an arrow on the back of each tile which indicates pile direction. Quarter turn installation is recommended for Gecko. The arrows should be at 90 degrees to the adjacent tile – also see diagram on page 2. Start laying with a full tile laid at the door, continuing to the middle of the room in parallel with the main wall (see diagram below).

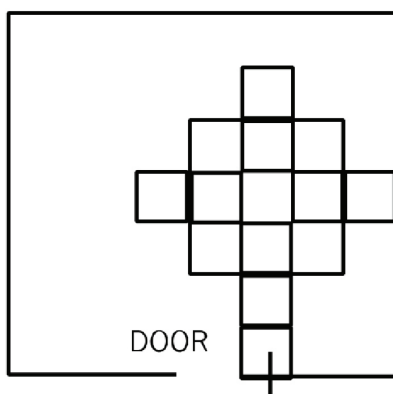

Make sure that no pile material is trapped between the tiles. This central point is a starting point for the gradual placement of the other pieces. It is necessary to apply good pressure when butting the tiles together for a neat fit.

(continued)

# Advance Carpet Tiles



For fiberglass reinforced PVC backed Gecko tiles

## Step 4

Recommended installation is quarter turn

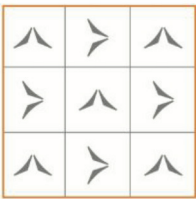

Quarter Turn

## Step 5

Finally, finishing the edges:

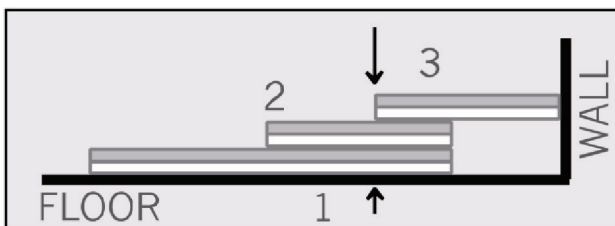

- Place the tile to be cut (2) on the tile laid last
- Slide a third tile (3) against the wall
- Cut the tile to be placed (2) along the edge of (3)
- Place the cut tile (2) against the wall

## Step 6

In doorways and other heavy-wear installations we recommend the use of a tackifier adhesive. Daily vacuum-cleaning will help maintain the appearance of the tiles. Never use solvents (white spirits, petrol, etc.), as they can affect the colour.

## Recommended Adhesive

Entrance matting applications - Giltgrip 88 - Gilt Edge Industries.

Strongbond 65 - Look Floors, Polymer 999 PS - Gilt Edge Industries Ltd & Mapei Ultrabond Eco Fix.